

SUNSET SF 120

MECHANICAL ASSEMBLY SYSTEM

Page 01-21

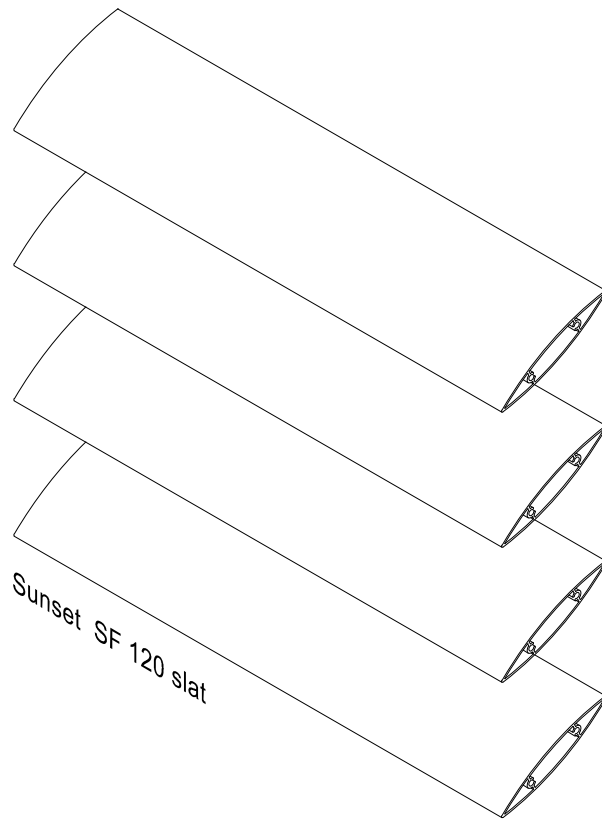
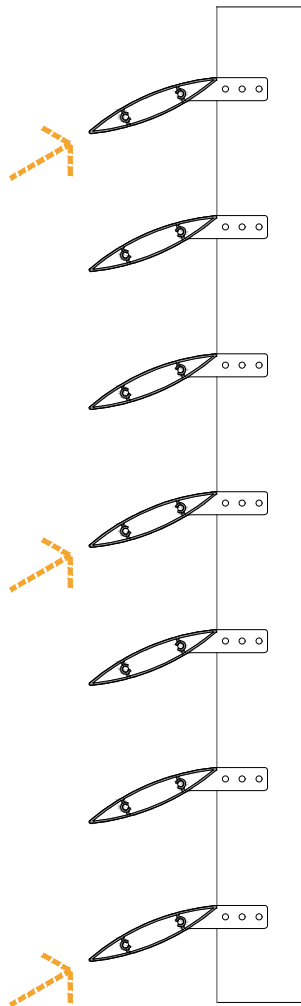

Technical department Simpleyfacil®
Specification workshop

Project:
Location:
Authorization:

Revision:
Revision:

Date: October 2020
Dimensions: mm. (in.)



SUNSET SF 120

SELECTION OF SUPPORTS ACCORDING TO THE SEPARATION BETWEEN ANCHORS

Page 02-21

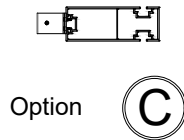
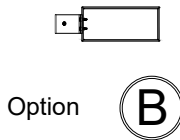
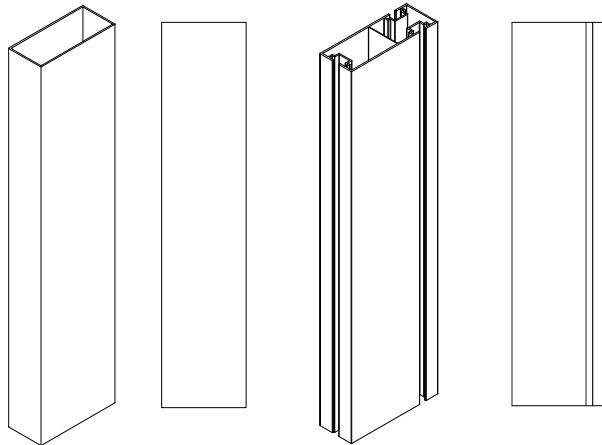

Components

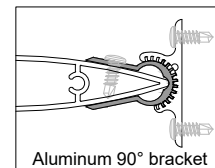
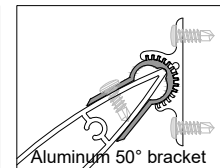
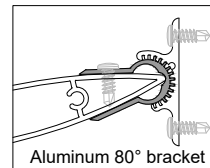
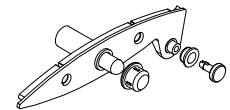
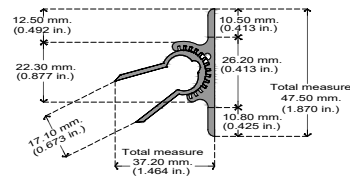
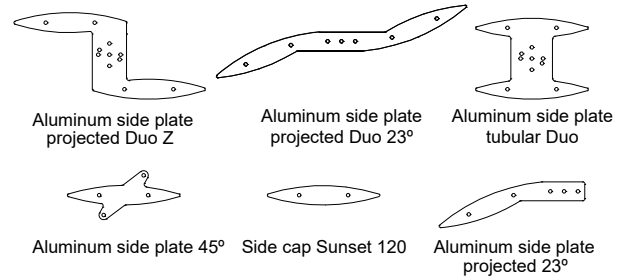

Distances for installation of structural supports

Nm Structural support options

- B Basic support 100X44 (3.93x1.73 in.)
- C Basic facade support 110X40 (4.33x1.57 in.)
- D Aluminum component anchored to construction site

Maximum distance between slat attachment horizontal installation
 Maximum distance between slat attachment vertical installation

Maximum distance (DA)

- 3300 mm. (129.92 in.)
- 4000 mm. (157.48 in.)
- >4000 mm.

Maximum distance (DV)

*See detail slat
 *See detail slat

- 1 Aluminium L bracket 4 x 4 x 1/4"
- 2 Aluminium L bracket 2 x 4 x 1/4"
- 3 Aluminium L bracket 2 x 2 x 1/4"

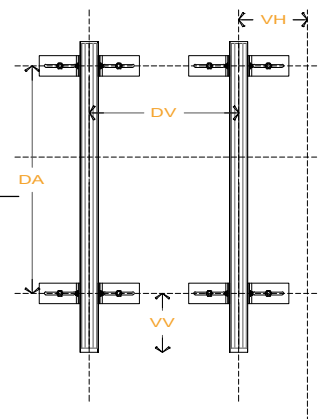
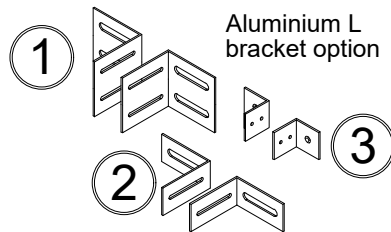

Nm Structural support options

- DA Maximum distance between structural support anchors
- DV Maximum distance between slat attachment
- VV Maximum vertical cantilever (support) 500 mm. (19.65 in.)
- VH Maximum horizontal cantilever (slat) 500 mm. (19.65 in.)

Technical department Simpleyfacil®
 Specification workshop

Revision:
 Revision:

Project:
 Location:
 Authorization:

Date: October 2020
 Dimensions: mm. (in.)



SUNSET SF 120

SPECIFICATION PARAMETERS AND TESTS (ALUMINUM SIDE PLATE PROJECTED 23°)

Page 03-21

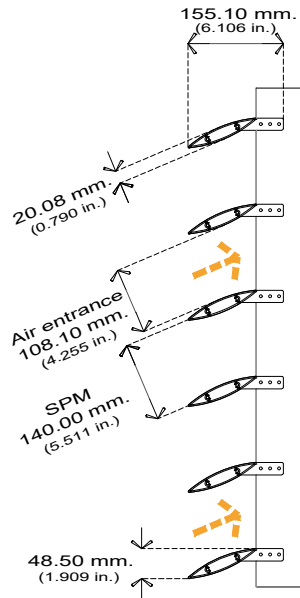

SPM 14 (23°)

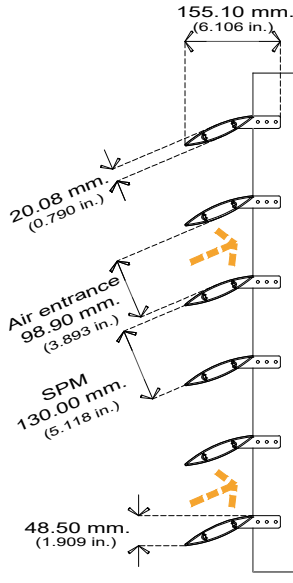

SPM 13 (23°)

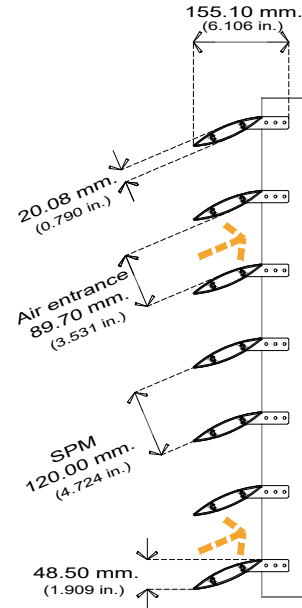

SPM 12 (23°)

The SPM are proposed by Simpleyfacil; the designer can set the separation according to the needs of your project

Number of slats per meter (SPM)

	7.14	7.69	8.33
Clearance between slats	140.01 mm. (5.512 in.)	130.00 mm. (5.118 in.)	120.00 mm. (4.724 in.)
Free area (%)	85.15%	84.00%	82.67%
DA Maximum distance between anchors, basic support installation (76 x 44 - 2.99x1.73 in.)		2700 mm. (106.29 in.)	
DA Maximum distance between anchors, basic support installation (100 x 44 - 3.93x1.73 in.)		3300 mm. (129.92 in.)	
DA Maximum distance between anchors, basic support installation (110 x 40 - 4.33x1.57 in.)		4000 mm. (157.48 in.)	
DV Maximum distance between slat attachment horizontal installation		2500 mm. (98.42 in.)	
DV Maximum distance between slat attachment vertical installation		2800 mm. (110.23 in.)	
Emittance according to ASTM C 1371 / Clear anodized and raw aluminium		0.645	
Reflectance according to ASTM C 1549 / Clear anodized and raw aluminium		0.759	
Accelerated aging to ASTM G151 / Clear anodized and raw aluminium		0.000	

Extruded aluminium alloy 6063, tempering T5, post-consumption content 51.60%, pre-consumption content 13.70% Snap-on anchored slats to vertical supports, without screws to avoid risk of oxidation

Technical department Simpleyfacil®
Specification workshop

Project:
Location:
Authorization:

Revision:
Revision:
Date: October 2020
Dimensions: mm. (in.)



SUNSET SF 120

SPECIFICATION PARAMETERS AND TESTS (ALUMINUM SIDE PLATE 45°)

Page 04-21

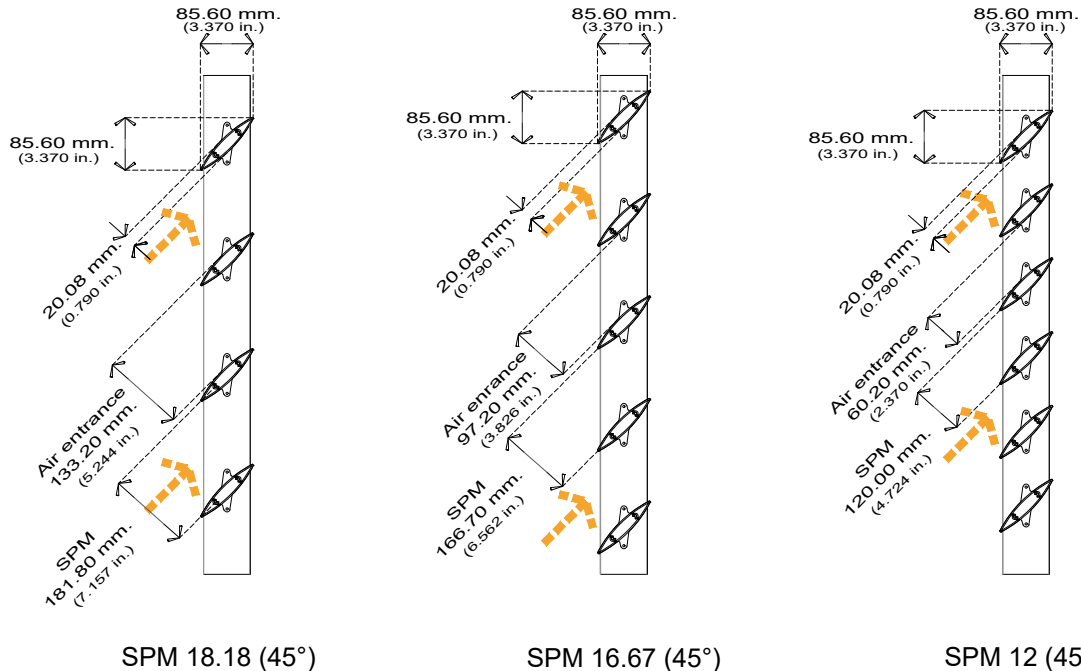

SPM 18.18 (45°)

SPM 16.67 (45°)

SPM 12 (45°)

The SPM are proposed by Simpleyfacil; the designer can set the separation according to the needs of your project

Number of slats per meter (SPM)

	5.50	6.00	8.33
Clearance between slats	181.80 mm. (7.157 in.)	166.70 mm. (6.562 in.)	120.00 mm. (4.724 in.)
Free area (%)	88.56%	87.52%	82.67%
DA Maximum distance between anchors, basic support installation (76 x 44 - 2.99x1.73 in.)		2700 mm. (106.29 in.)	
DA Maximum distance between anchors, basic support installation (100 x 44 - 3.93x1.73 in.)		3300 mm. (129.92 in.)	
DA Maximum distance between anchors, basic support installation (110 x 40 - 4.33x1.57 in.)		4000 mm. (157.48 in.)	
DV Maximum distance between slat attachment horizontal installation		2500 mm. (98.42 in.)	
DV Maximum distance between slat attachment vertical installation		3000 mm. (118.11 in.)	
Emittance according to ASTM C 1371 / Clear anodized and raw aluminium		0.645	
Reflectance according to ASTM C 1549 / Clear anodized and raw aluminium		0.759	
Accelerated aging to ASTM G151 / Clear anodized and raw aluminium		0.000	

Extruded aluminium alloy 6063, tempering T5, post-consumption content 51.60%, pre-consumption content 13.70% Snap-on anchored slats to vertical supports, without screws to avoid risk of oxidation

Technical department Simpleyfacil®
Specification workshop

Revision:
Revision:

Project:
Location:
Authorization:

Date: October 2020
Dimensions: mm. (in.)



SUNSET SF 120

SPECIFICATION PARAMETERS AND TESTS (ALUMINUM SIDE PLATE PROJECTED DUO 23°)

Page 05-21

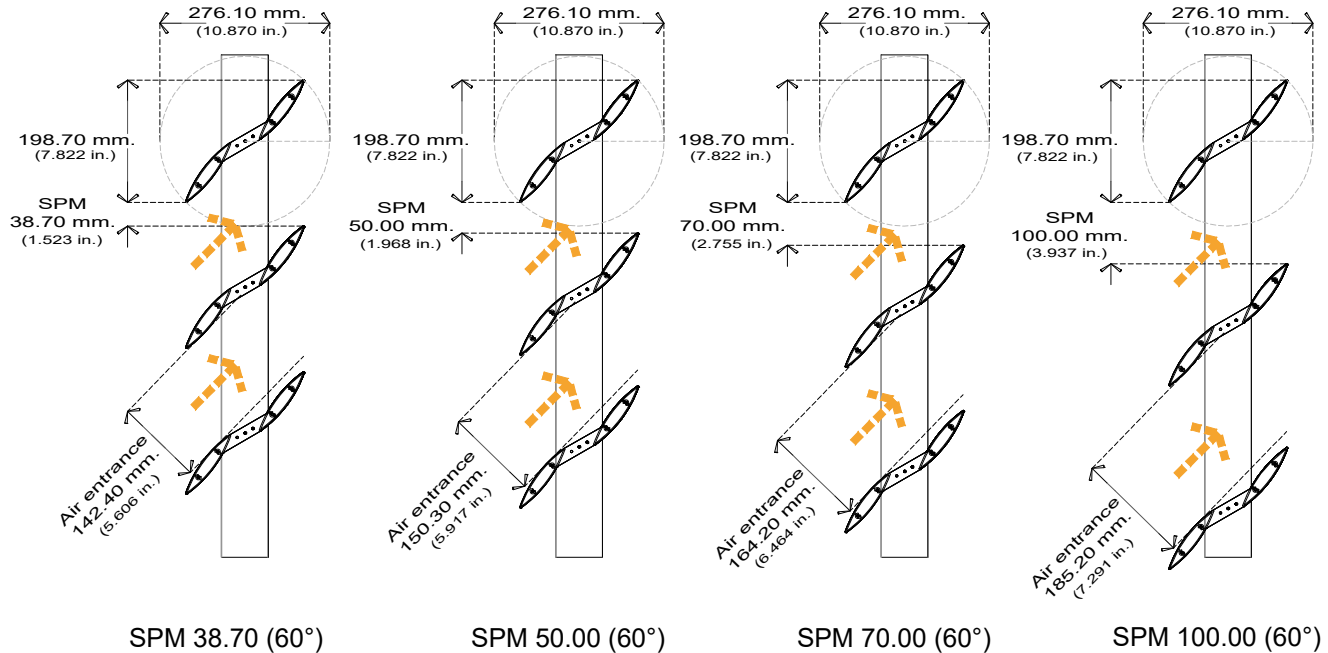

The SPM are proposed by Simpleyfácil; the designer can set the separation according to the needs of your project

Number of slats per meter (SPM)

	8.42	8.04	7.44	6.69
Clearance between slats	38.70 mm. (1.523 in.)	50.00 mm. (1.968 in.)	70.00 mm. (2.755 in.)	100.00 mm. (3.937 in.)
Free area (%)	72.16%	73.20%	74.95%	77.10%
DA Maximum distance between anchors, basic support installation (76 x 44 - 2.99x1.73 in.)			2700 mm. (106.29 in.)	
DA Maximum distance between anchors, basic support installation (100 x 44 - 3.93x1.73 in.)			3300 mm. (129.92 in.)	
DA Maximum distance between anchors, basic support installation (110 x 40 - 4.33x1.57 in.)			4000 mm. (157.48 in.)	
DV Maximum distance between slat attachment horizontal installation			2500 mm. (98.42 in.)	
DV Maximum distance between slat attachment vertical installation			3000 mm. (118.11 in.)	
Emittance according to ASTM C 1371 / Clear anodized and raw aluminium			0.645	
Reflectance according to ASTM C 1549 / Clear anodized and raw aluminium			0.759	
Accelerated aging to ASTM G151 / Clear anodized and raw aluminium			0.000	

Extruded aluminium alloy 6063, tempering T5, post-consumption content 51.60%, pre-consumption content 13.70% Snap-on anchored slats to vertical supports, without screws to avoid risk of oxidation

Technical department Simpleyfácil®
Specification workshop

Project:
Location:
Authorization:

Revision:
Revision:
Date: October 2020
Dimensions: mm. (in.)



SUNSET SF 120

SPECIFICATION PARAMETERS AND TESTS (ALUMINUM SIDE PLATE PROJECTED DUO Z 90°)

Page 06-21

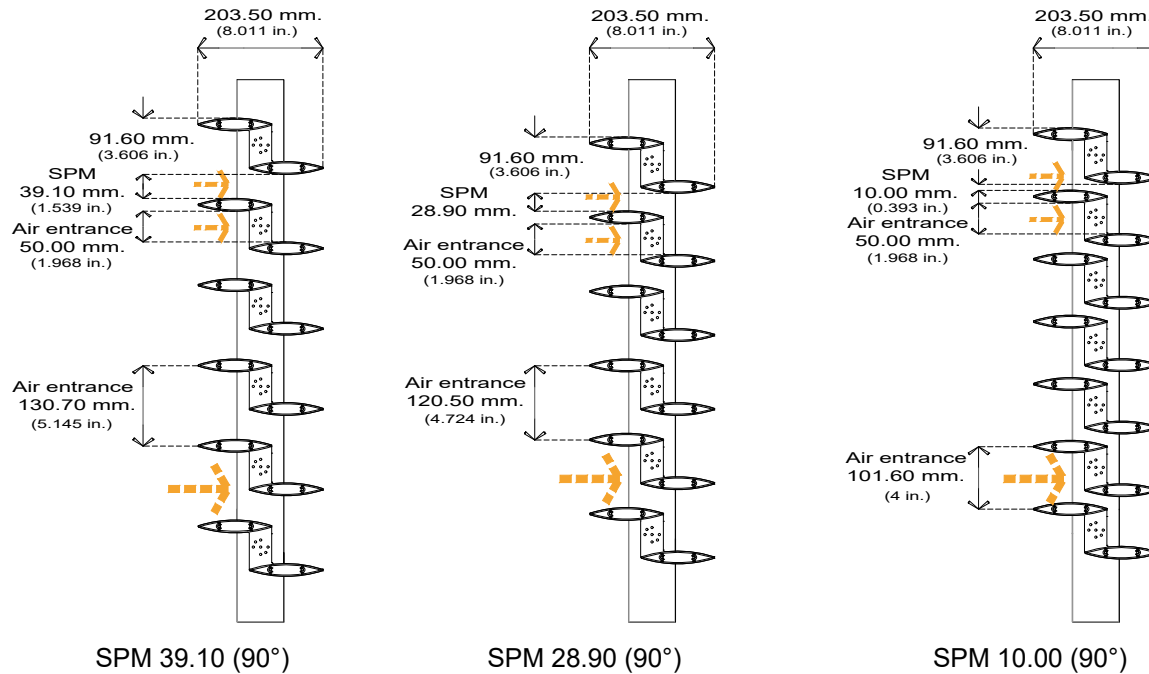

The SPM are proposed by Simpleyfacil; the designer can set the separation according to the needs of your project

Number of slats per meter (SPM)

	15.30	16.59	19.68
Clearance between slats	39.10 mm. (1.523 in.)	28.90 mm. (1.137 in.)	10.00 mm. (0.393 in.)
Free area (%)	68.18%	62.52%	59.06%
DA Maximum distance between anchors, basic support installation (76 x 44 - 2.99x1.73 in.)		2700 mm. (106.29 in.)	
DA Maximum distance between anchors, basic support installation (100 x 44 - 3.93x1.73 in.)		3300 mm. (129.92 in.)	
DA Maximum distance between anchors, basic support installation (110 x 40 - 4.33x1.57 in.)		4000 mm. (157.48 in.)	
DV Maximum distance between slat attachment horizontal installation		2500 mm. (98.42 in.)	
DV Maximum distance between slat attachment vertical installation		3500 mm. (137.79 in.)	
Emittance according to ASTM C 1371 / Clear anodized and raw aluminium		0.645	
Reflectance according to ASTM C 1549 / Clear anodized and raw aluminium		0.759	
Accelerated aging to ASTM G151 / Clear anodized and raw aluminium		0.000	

Extruded aluminium alloy 6063, tempering T5, post-consumption content 51.60%, pre-consumption content 13.70% Snap-on anchored slats to vertical supports, without screws to avoid risk of oxidation

Technical department Simpleyfacil®
Specification workshop

Revision:
Revision:

Project:
Location:
Authorization:

Date: October 2020
Dimensions: mm. (in.)



SUNSET SF 120

SPECIFICATION PARAMETERS AND TESTS (ALUMINUM SIDE PLATE TUBULAR DUO Z 90°)

Page 07-21

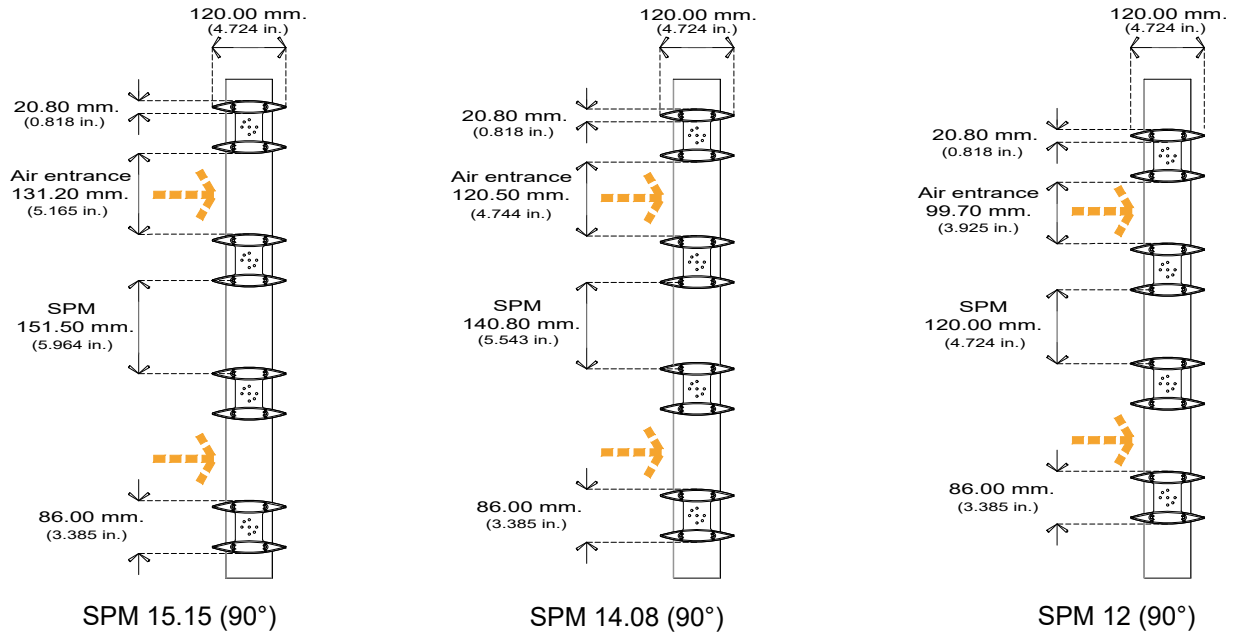

The SPM are proposed by Simpleyfacil; the designer can set the separation according to the needs of your project

Number of slats per meter (SPM)

	13.20	14.20	16.66
Clearance between slats	151.50 mm. (5.964 in.)	140.80 mm. (5.511 in.)	120.00 mm. (4.724 in.)
Free area (%)	72.54%	70.46%	65.35%
DA Maximum distance between anchors, basic support installation (76 x 44 - 2.99x1.73 in.)		2700 mm. (106.29 in.)	
DA Maximum distance between anchors, basic support installation (100 x 44 - 3.93x1.73 in.)		3300 mm. (129.92 in.)	
DA Maximum distance between anchors, basic support installation (110 x 40 - 4.33x1.57 in.)		4000 mm. (157.48 in.)	
DV Maximum distance between slat attachment horizontal installation		2500 mm. (98.42 in.)	
DV Maximum distance between slat attachment vertical installation		3500 mm. (137.79 in.)	
Emittance according to ASTM C 1371 / Clear anodized and raw aluminium		0.645	
Reflectance according to ASTM C 1549 / Clear anodized and raw aluminium		0.759	
Accelerated aging to ASTM G151 / Clear anodized and raw aluminium		0.000	

Extruded aluminium alloy 6063, tempering T5, post-consumption content 51.60%, pre-consumption content 13.70% Snap-on anchored slats to vertical supports, without screws to avoid risk of oxidation

Technical department Simpleyfacil®
Specification workshop

Revision:
Revision:

Project:
Location:
Authorization:

Date: October 2020
Dimensions: mm. (in.)



SUNSET SF 120

SPECIFICATION PARAMETERS AND TESTS (ALUMINUM BRACKETS VARIABLE DEGREES)

Page 08-21

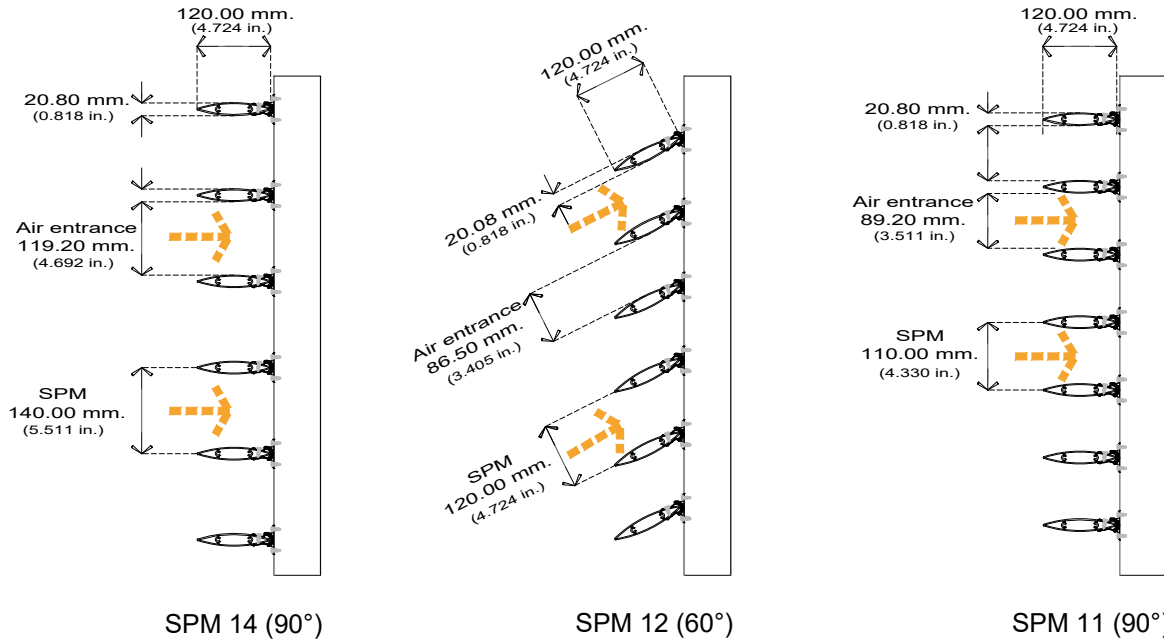

The SPM are proposed by Simpleyfacil; the designer can set the separation according to the needs of your project

Number of slats per meter (SPM)

	7.14	8.33	9.09
Clearance between slats	140.10 mm. (5.515 in.)	120.00 mm. (4.724 in.)	110.00 mm. (4.330 in.)
Free area (%)	85.15%	82.67%	81.09%
DA Maximum distance between anchors, basic support installation (76 x 44 - 2.99x1.73 in.)		2700 mm. (106.29 in.)	
DA Maximum distance between anchors, basic support installation (100 x 44 - 3.93x1.73 in.)		3300 mm. (129.92 in.)	
DA Maximum distance between anchors, basic support installation (110 x 40 - 4.33x1.57 in.)		4000 mm. (157.48 in.)	
DV Maximum distance between slat attachment horizontal installation		2500 mm. (98.42 in.)	
DV Maximum distance between slat attachment vertical installation		2800 mm. (110.23 in.)	
Emittance according to ASTM C 1371 / Clear anodized and raw aluminium		0.645	
Reflectance according to ASTM C 1549 / Clear anodized and raw aluminium		0.759	
Accelerated aging to ASTM G151 / Clear anodized and raw aluminium		0.000	

Extruded aluminium alloy 6063, tempering T5, post-consumption content 51.60%, pre-consumption content 13.70% Snap-on anchored slats to vertical supports, without screws to avoid risk of oxidation

Technical department Simpleyfacil®
Specification workshop

Revision:
Revision:

Project:
Location:
Authorization:

Date: October 2020
Dimensions: mm. (in.)



SUNSET SF 120

ANCHORING TO SLABS WITH STRUCTURAL SUPPORT 100 X 44 mm. (3.93X1.73 in.)

Page 09-21

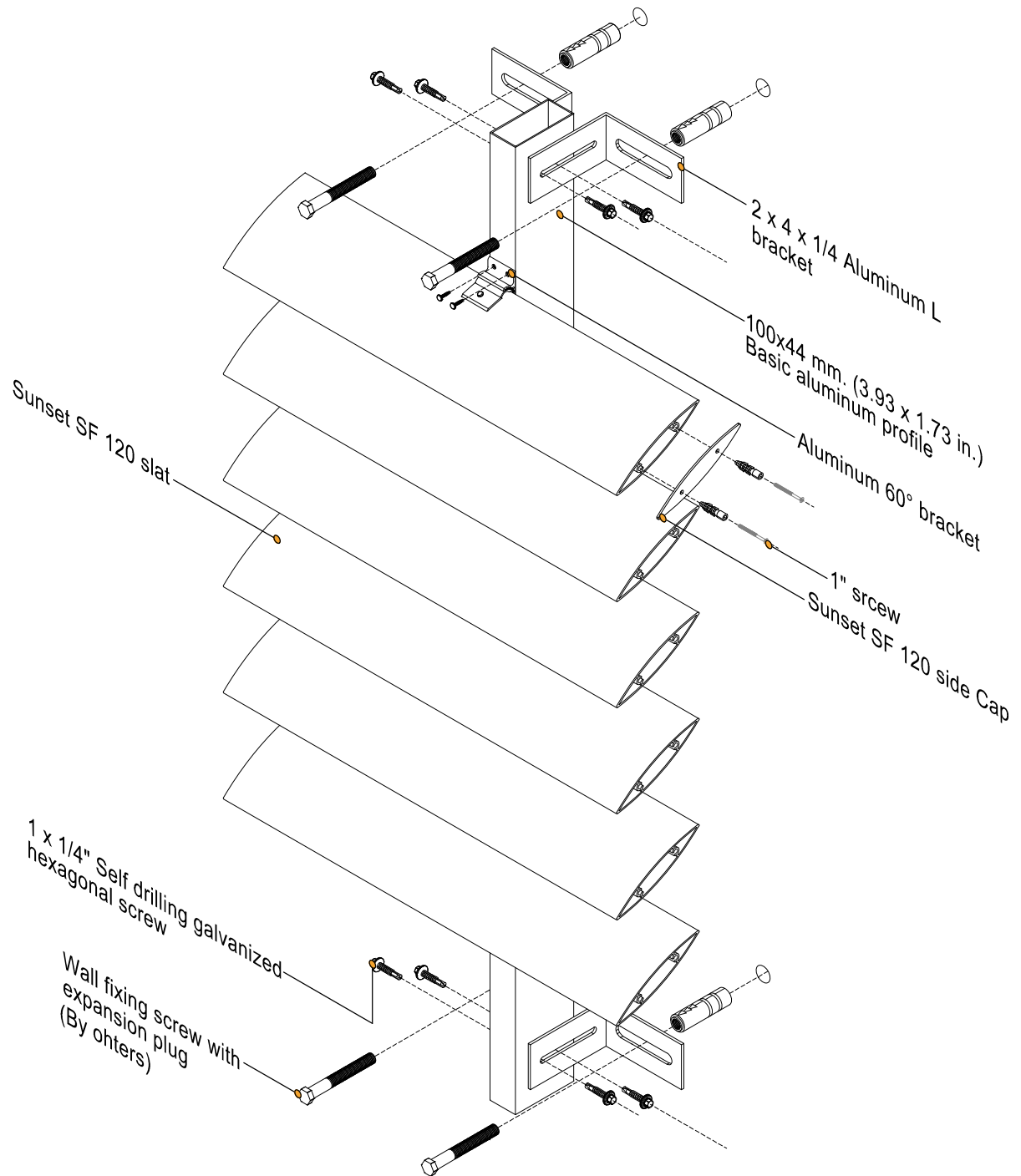

Technical department Simpleyfacil®
Specification workshop

Project:
Location:
Authorization:

Revision:
Revision:
Date: October 2020
Dimensions: mm. (in.)



SUNSET SF 120

ACHORING TO SLABS WITH STRUCTURAL SUPPORT 110 X 40 mm. (4.33X1.57 in.)

Page 10-21

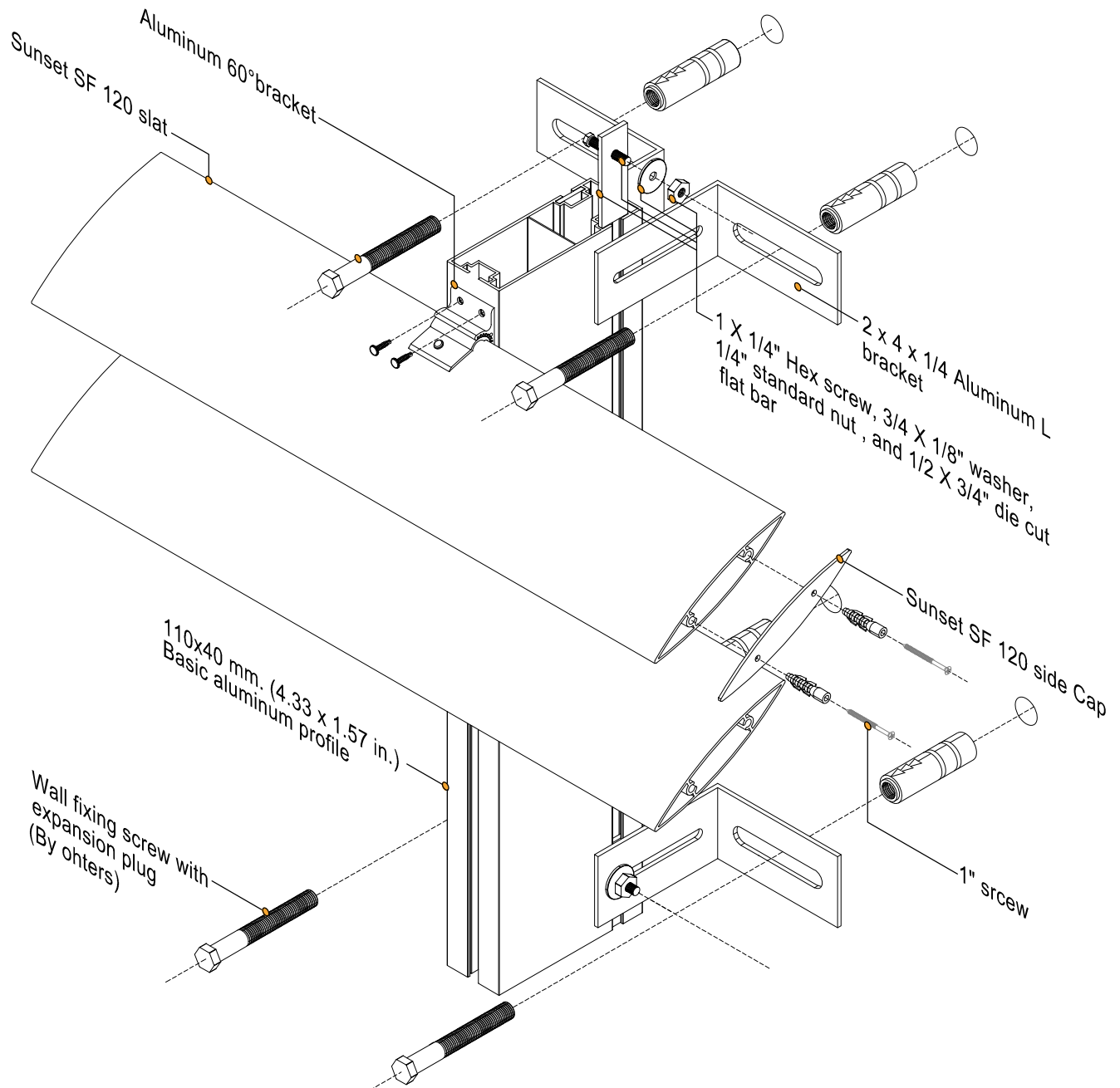

Technical department Simpleyfacil®
Specification workshop

Project:
Location:
Authorization:

Revision:
Revision:
Date: October 2020
Dimensions: mm. (in.)



SUNSET SF 120

ANCHORAGE TO SUB STRUCTURE (RHS) PROVIDED BY THE CLIENT

Page 11-21

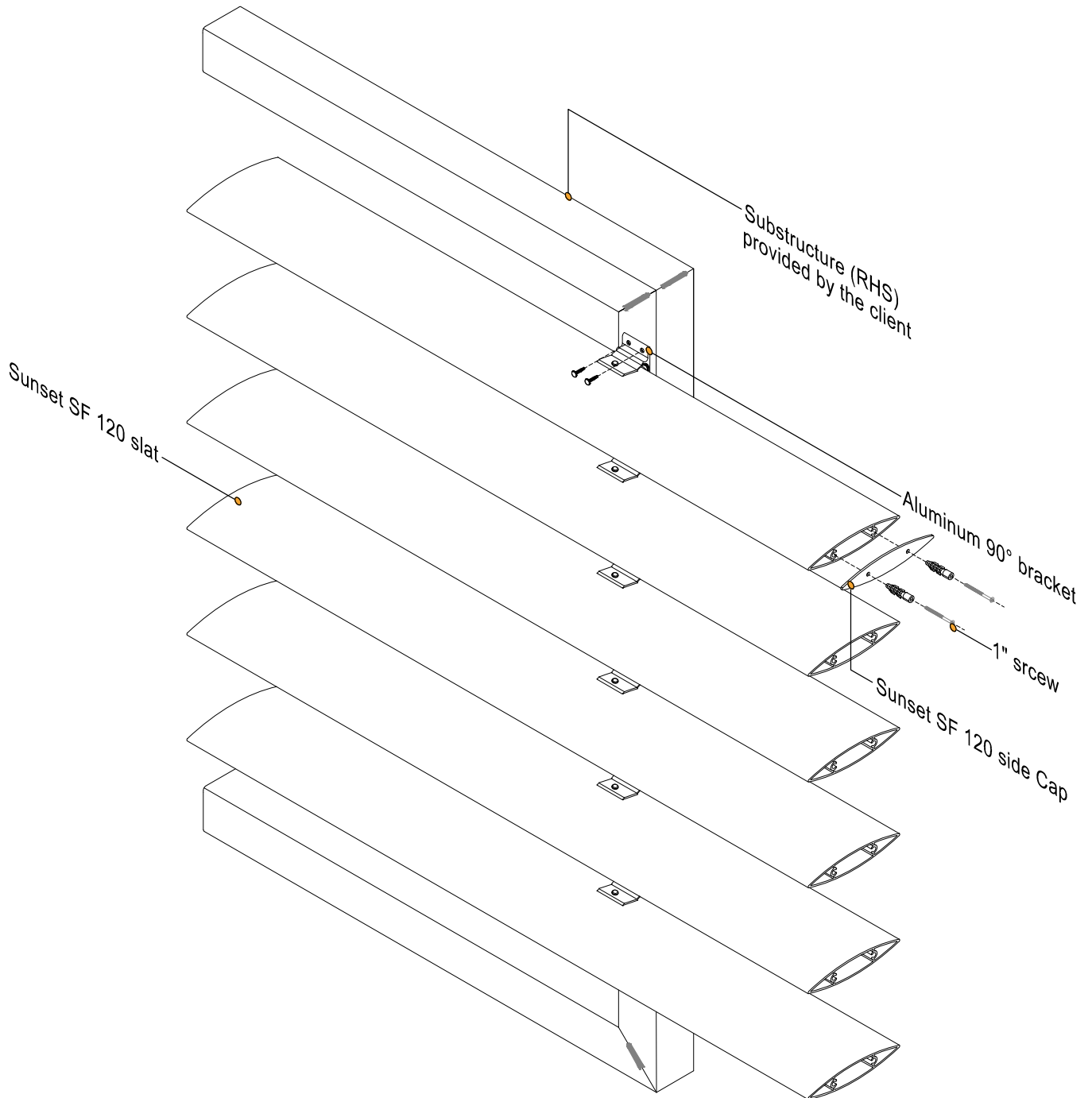

Technical department Simpleyfacil®
Specification workshop

Project:
Location:
Authorization:

Revision:
Revision:
Date: October 2020
Dimensions: mm. (in.)



SUNSET SF 120

FACADE PROPOSAL (ALUMINUM SIDE PLATE PROJECTED 23°)

Page 12-21

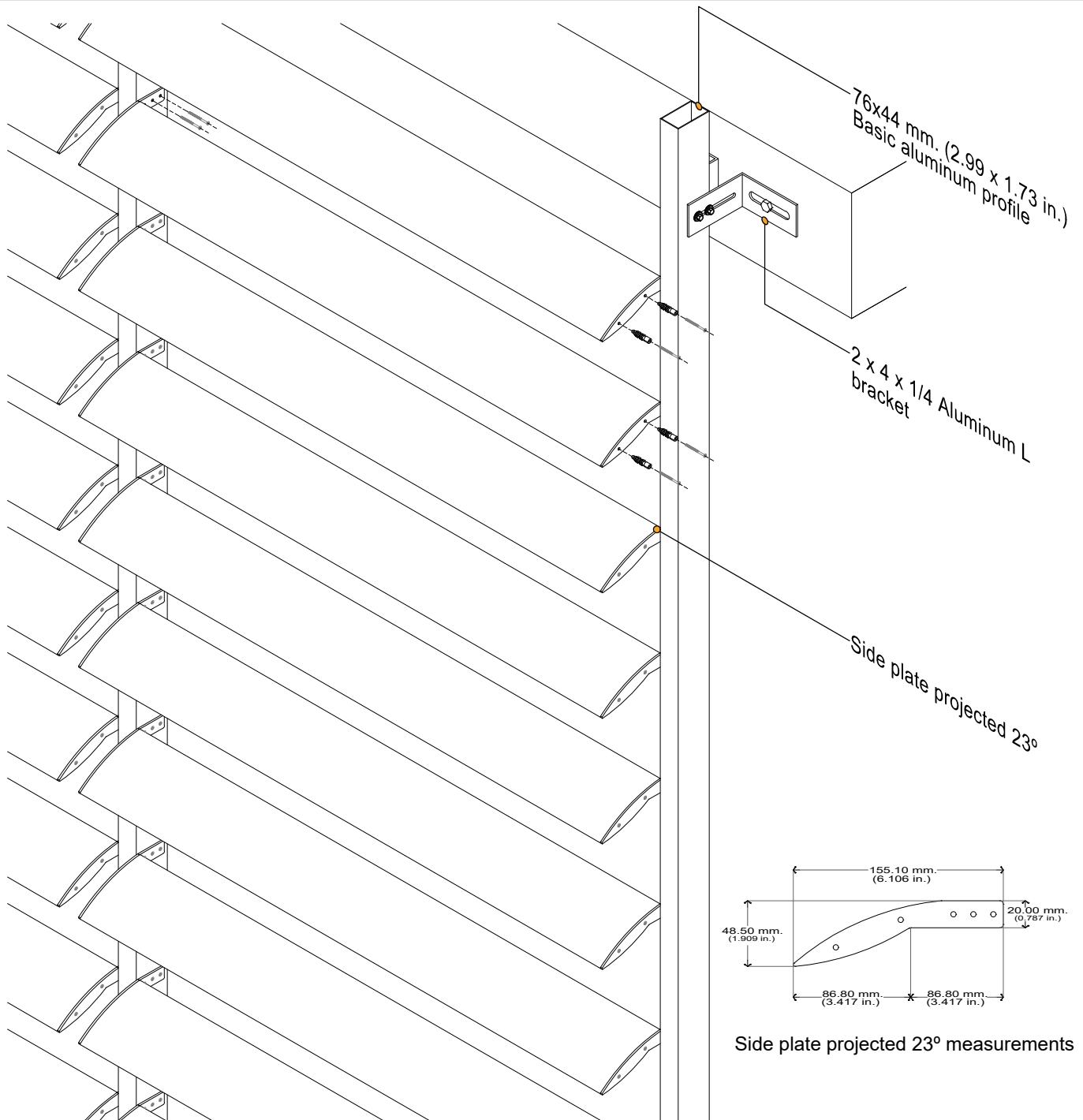

Technical department Simpleyfacil®
Specification workshop

Project:
Location:
Authorization:

Revision:
Revision:
Date: October 2020
Dimensions: mm. (in.)



SUNSET SF 120

FACADE PROPOSAL IN BUILDING SPAN (ALUMINUM SIDE PLATE 45°)

Page 13-21

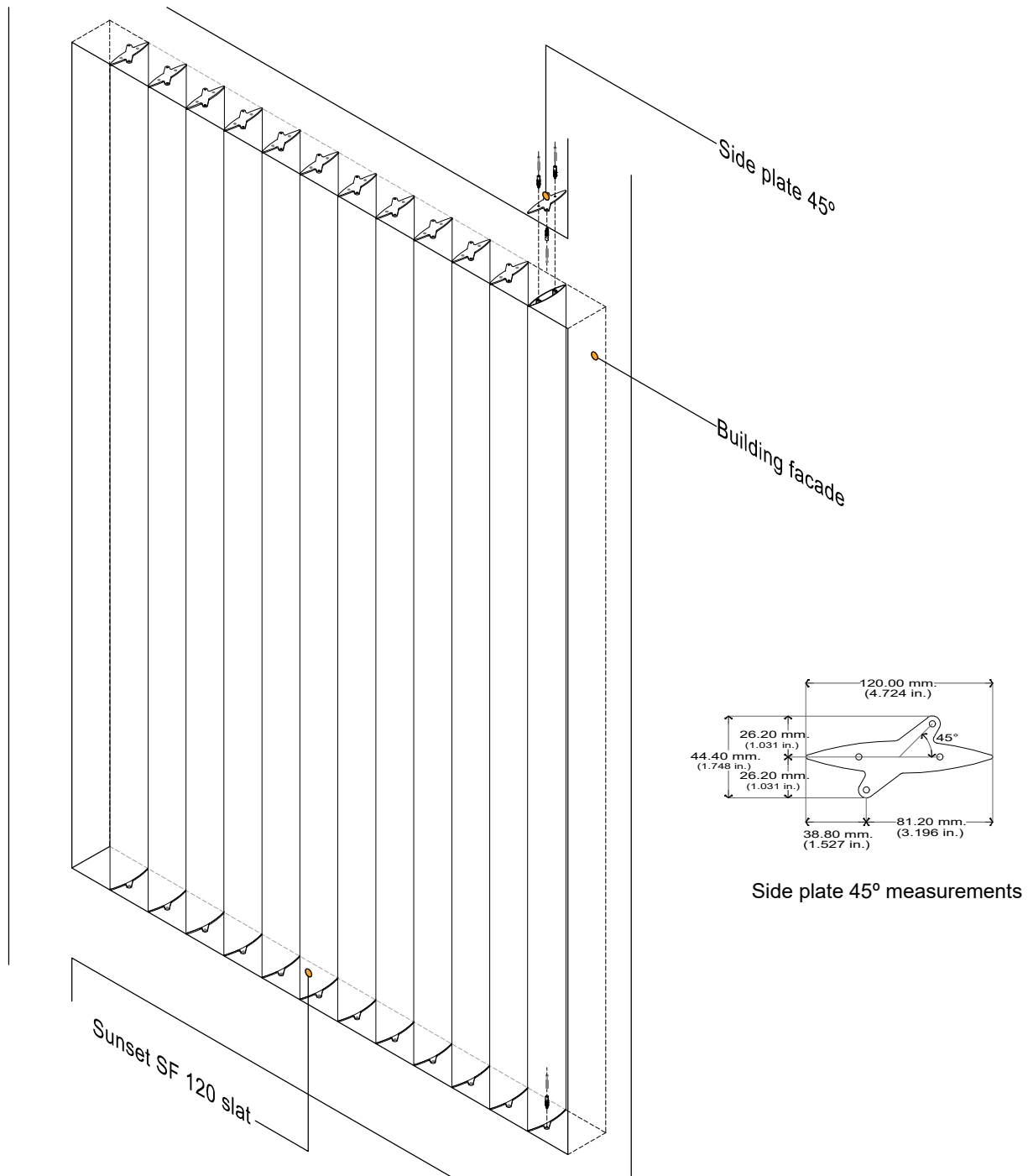

Technical department Simpleyfacil®
Specification workshop

Project:
Location:
Authorization:

Revision:
Revision:
Date: October 2020
Dimensions: mm. (in.)



SUNSET SF 120

FACADE PROPOSAL IN BUILDING SPAN (ALUMINUM SIDE PLATE PROJECTED DUO 23°)

Page 14-21

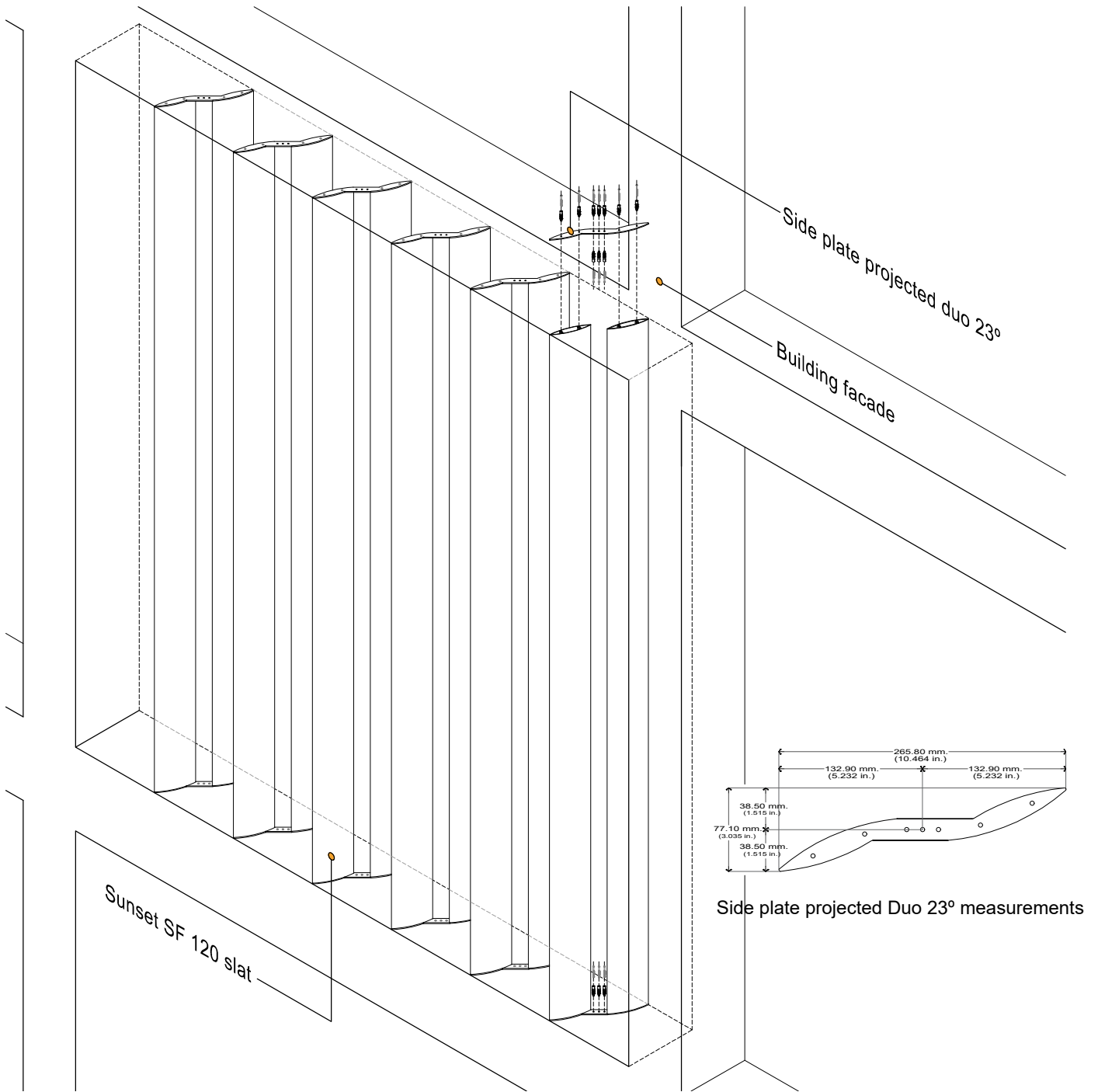

Technical department Simpleyfácil®
Specification workshop

Project:
Location:
Authorization:

Revision:
Revision:
Date: October 2020
Dimensions: mm. (in.)



SUNSET SF 120

FACADE PROPOSAL IN BUILDING SPAN (ALUMINUM SIDE PLATE DUO Z)

Page 15-21

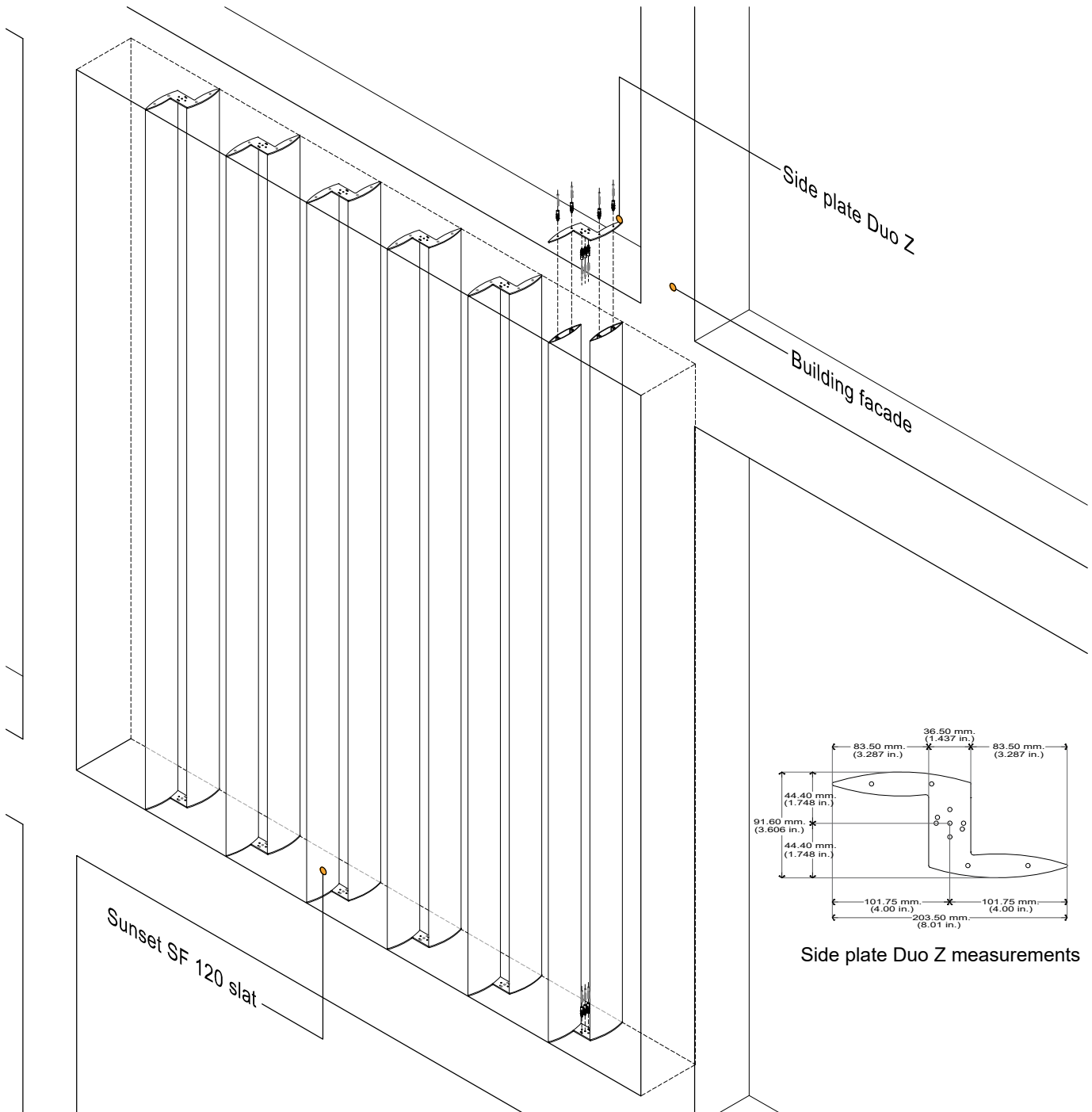

Technical department Simpleyfácil®
Specification workshop

Project:
Location:
Authorization:

Revision:
Revision:
Date: October 2020
Dimensions: mm. (in.)



SUNSET SF 120

FACADE PROPOSAL IN BUILDING SPAN (ALUMINUM SIDE PLATE TUBULAR DUO)

Page 16-21

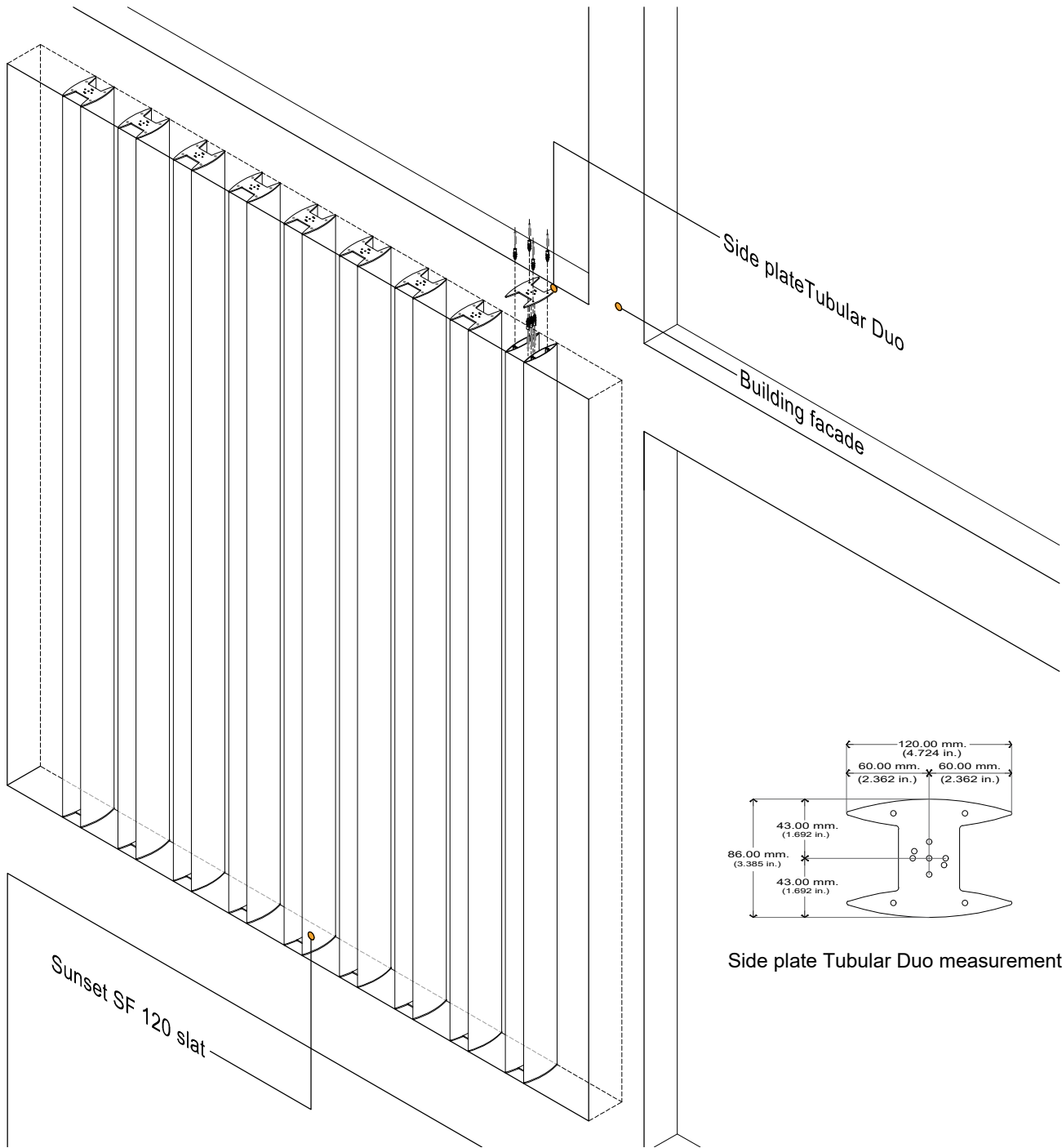

Side plate Tubular Duo measurements

Technical department Simpleyfacil®
Specification workshop

Project:
Location:
Authorization:

Revision:
Revision:
Date: October 2020
Dimensions: mm. (in.)



SUNSET SF 120

VERTICAL FACADE PROPOSAL (WALL ANCHORING BRACKETS 90°)

Page 17-21

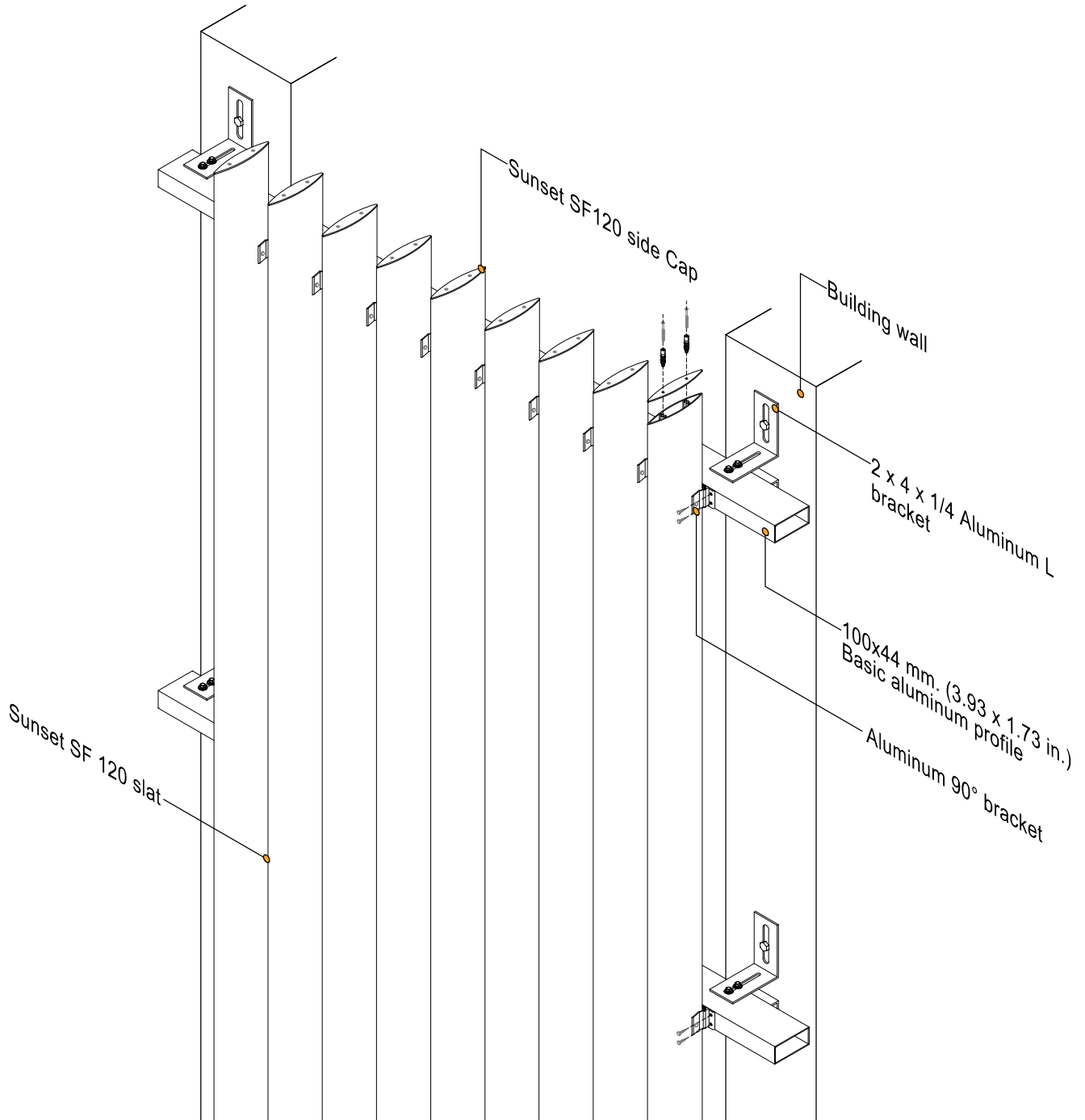

Technical department Simpleyfácil®
Specification workshop

Project:
Location:
Authorization:

Revision:
Revision:
Date: October 2020
Dimensions: mm. (in.)



SUNSET SF 120

FACADE PROPOSAL (ALUMINUM 90° BRACKET)

Page 18-21

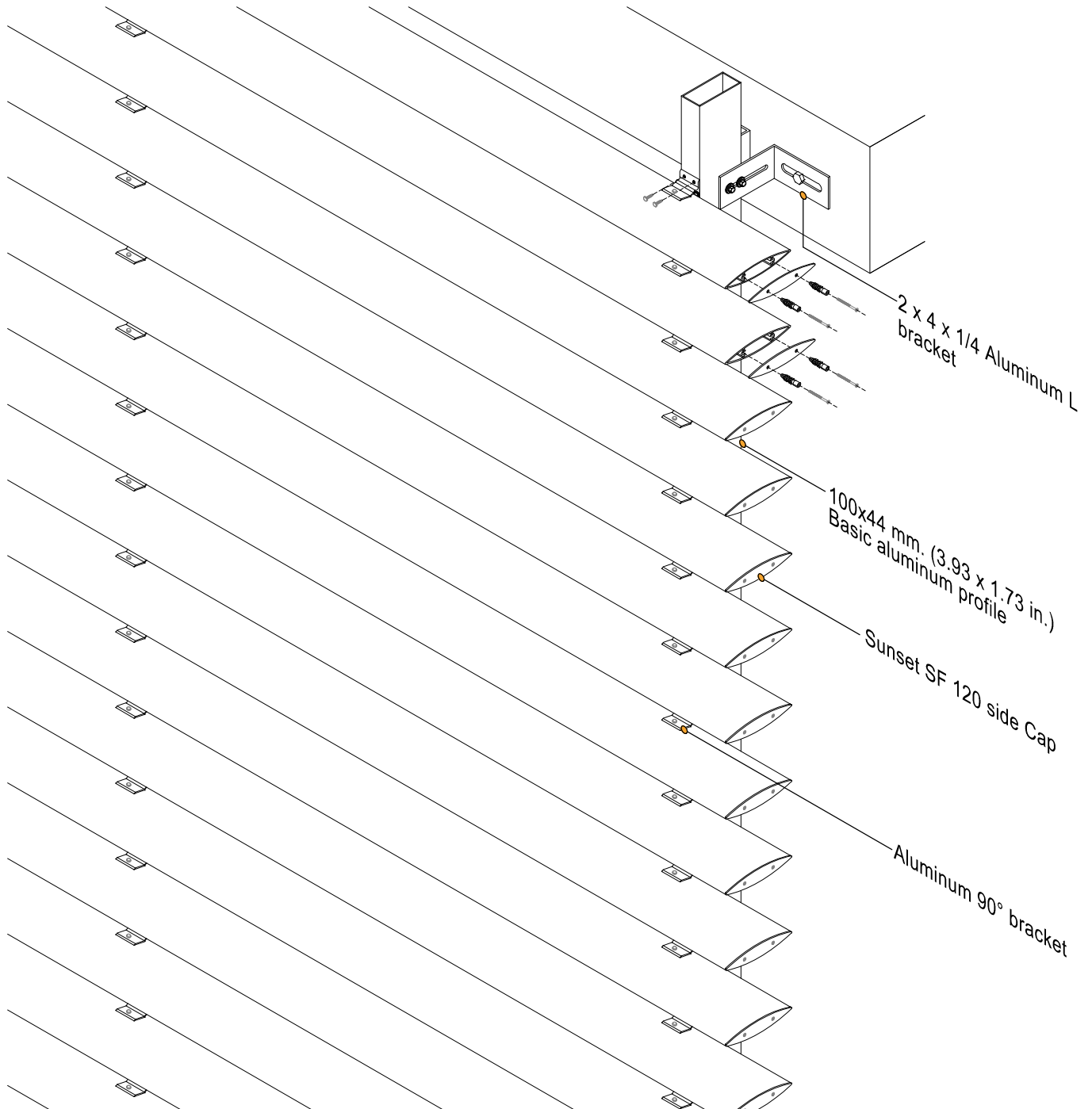

Technical department Simpleyfacil®
Specification workshop

Project:
Location:
Authorization:

Revision:
Revision:
Date: October 2020
Dimensions: mm. (in.)



SUNSET SF 120

DETAIL OF MOBILE SLAT SYSTEM COMPONENTS

Page 19-21

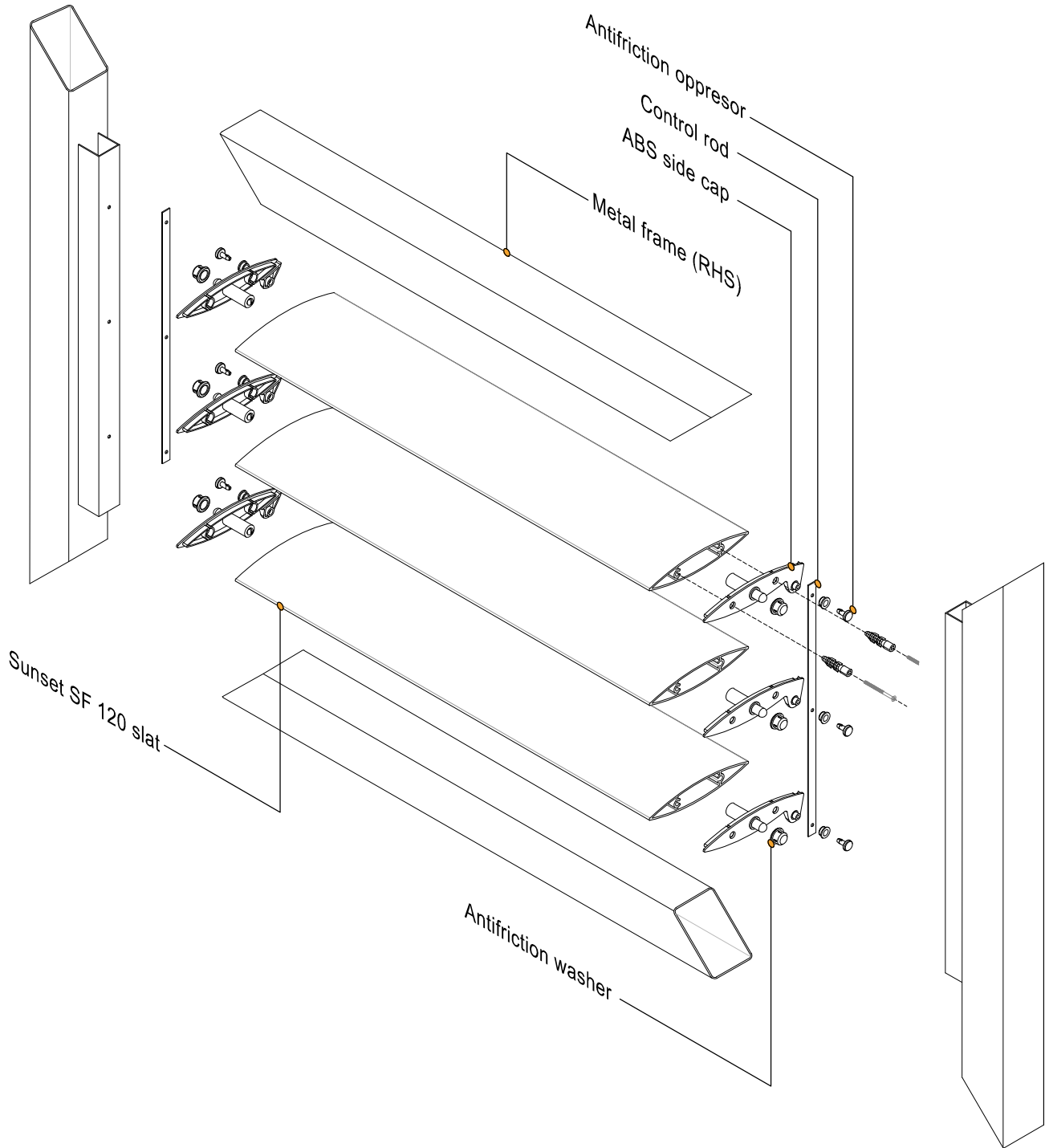

Technical department Simpleyfacil®
Specification workshop

Project:
Location:
Authorization:

Revision:
Revision:
Date: October 2020
Dimensions: mm. (in.)



SUNSET SF 120

SUNSET SF MOBILE SYSTEM DETAIL (MOTORIZED AND MANUAL SLAT IN WINDOW SPACE)

Page 20-21

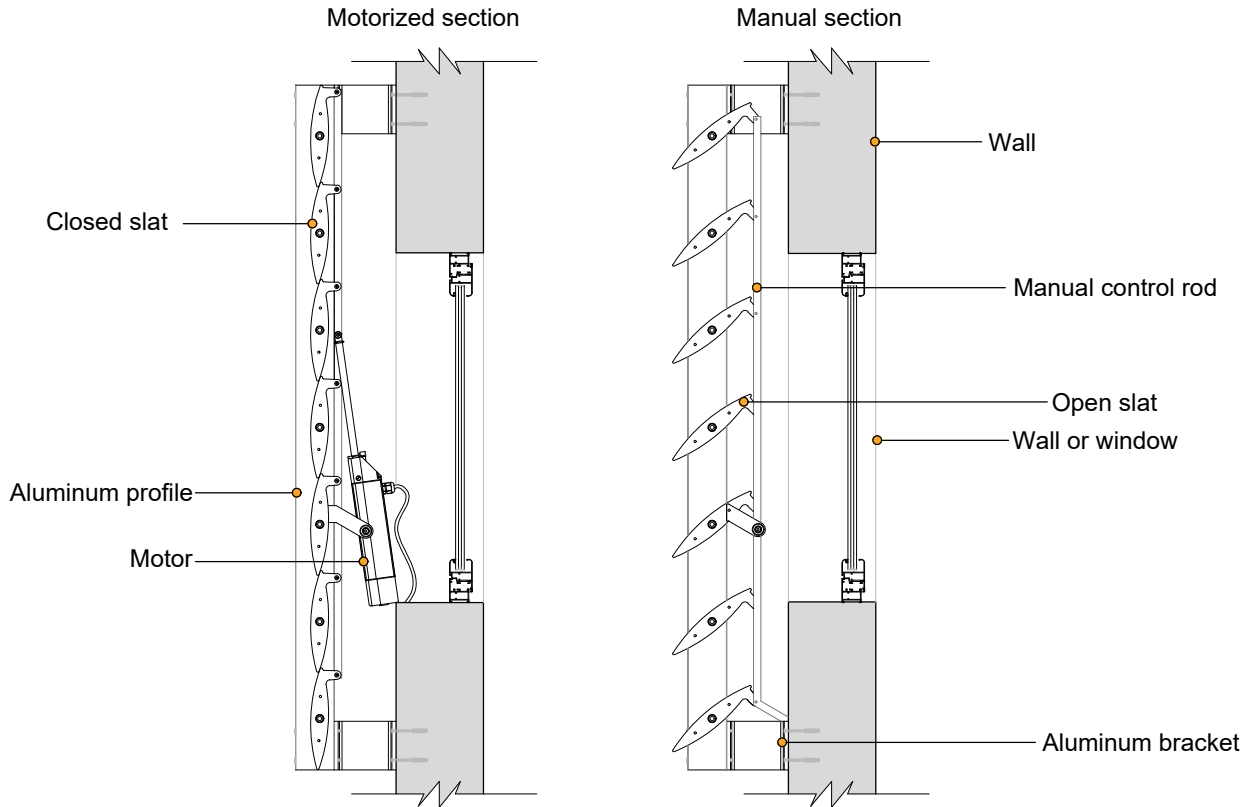

Number of slats per meter (SPM)

8.57

Clearance between slats 100.20 mm. (3.944 in.)

DV Maximum distance between slat attachment horizontal installation 2000 mm. (78.740 in.)

DV Maximum distance between slat attachment vertical installation 2000 mm. (78.740 in.)

Emittance according to ASTM C 1371 / Clear anodized and raw aluminium 0.645

Reflectance according to ASTM C 1549 / Clear anodized and raw aluminium 0.759

Accelerated aging to ASTM G151 / Clear anodized and raw aluminium 0.000

Extruded aluminium alloy 6063, tempering T5, post-consumption content 51.60%, pre-consumption content 13.70% Snap-on anchored slats to vertical supports, without screws to avoid risk of oxidation

Technical department Simpleyfácil®
Specification workshop

Revision:

Revision:

Project:

Location:

Authorization:

Date: October 2020

Dimensions: mm. (in.)



SUNSET SF 120

SUNSET SF MOBILE SYSTEM DETAIL (MOTORIZED SLAT INSIDE THE DOME)

Page 21-21

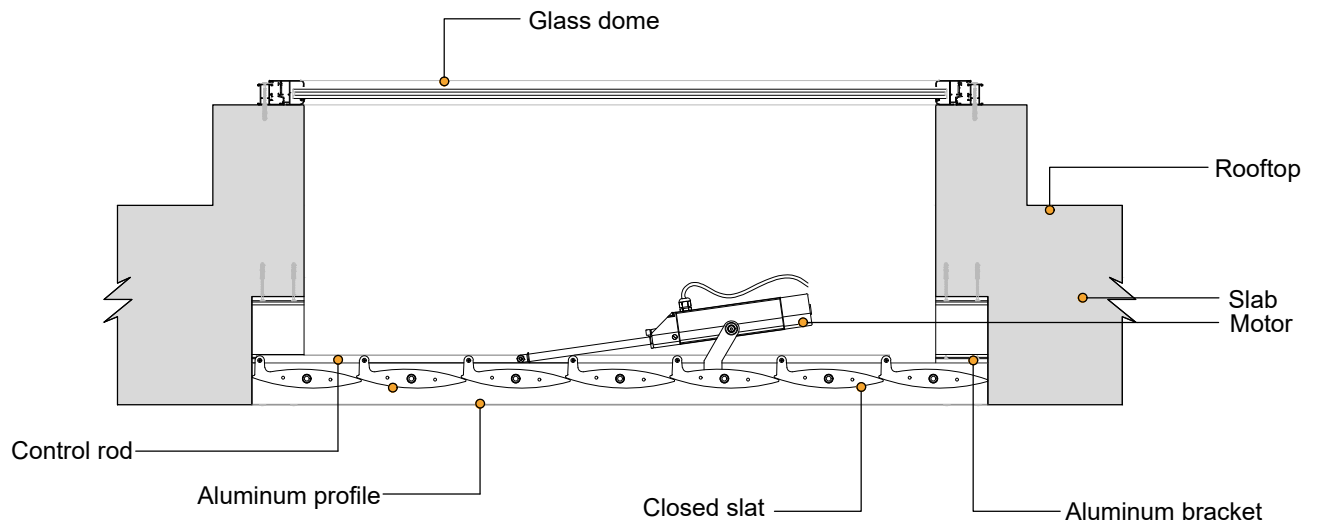
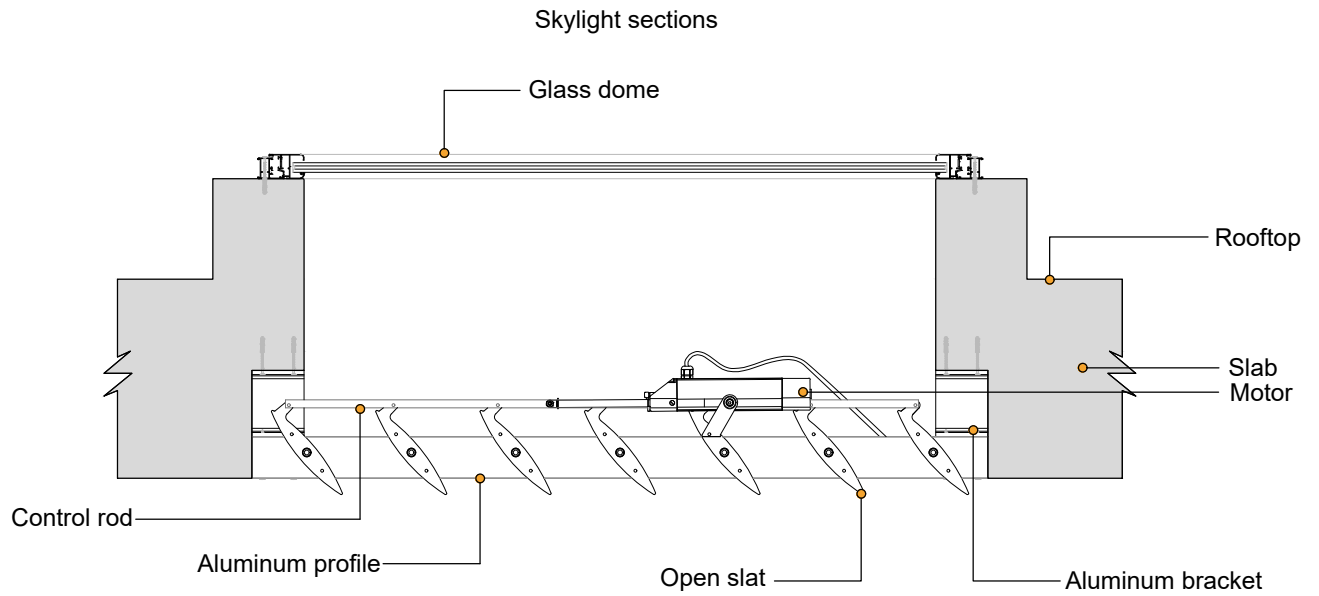

Technical department Simpleyfacil®
Specification workshop

Project:
Location:
Authorization:

Revision:
Revision:
Date: October 2020
Dimensions: mm. (in.)

